

So our world has collapsed,
We're going to Rebuild,
Myself and the Design leader,
will listen

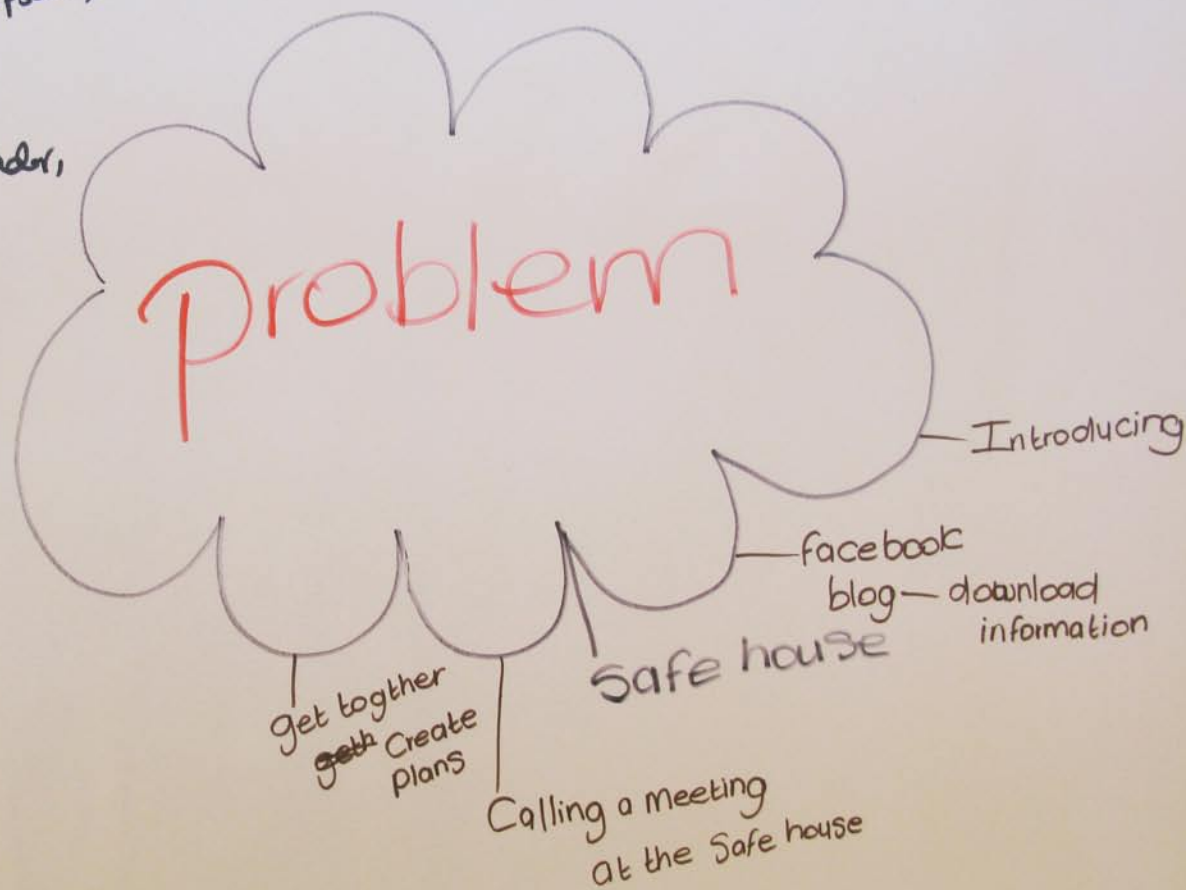

Communication Problems

RAY GUN PROOF-MS

How do we make an effective skill, need to know strength of the key?

Someone needs to know this... find it out.

Designs need to know what it is.

Define the human resources we have

Build a Management Structure.

What happens if everyone wants to be in charge?

Everyone will die!

Take the majority.

Everyone's views count.

What about disagreements?

Choose a leader by a vote

2 Leaders. Design Client. Assistant Supervisor.

Scheduled meetings

Triple feedback?

Brief updates.

Internet still works

Can start a blog to communicate plans.

What if the design team makes a mistake?

Both leaders work as clearly as possible

Clear information

Initial meetings

Product Test / Quality Test

Get everyone & design as a group.

MIRRORED? Is it a good idea?

Work client & design team.

Knowledge base

Power? Online Library

Do it Right / Do it Once.

Designs need Approval at each stage of design

Effective Delegation

Specific + Clear

Measurable.

Time keeping

Always

This will help our design

Make sure leaders are all clear + are good Delegates.

Communication Problems

LOW GOV PROF-NESS

How do we make an effective shield, need to know strength of the key?
Requires need to know what it is.

Someone needs to know this... find it out.

Take the majority.

What about disagreements?
Everyone votes count.

What happens if everyone wants to be in charge?
Everyone will die!

Choose a leader by a vote
2 Leaders: Design / Client.
Assistant / Supervisor.

What if the design team makes a rewrite?
Both leaders work as closely as possible - clear information
Inter-negotiate

Internet Skills

Can start a blog to communicate plans.

Product Test / Quality Test

MARKETING

Is this your idea?
Worst client = someone who knows what they want.

Get the best out of everyone & design as a group.

Knowledge base

Power? Online Library

Define the human resources we have
Build a Management Structure.

Do it Right / Do it Once.

Designers need Approval at each stage of design.

Effective Delegation

Specific + Clear + Measurable.
Time keeping

Always think will help us achieve our goal.

Make sure leaders are all clear + are good delegates.



Delegation

- 1 Specifics, clear
- 2 MEASURABLE.
- 3 TIME Limit.

TEAM

ANDY
~~DESIGN~~

LEAD
BOSS

PROJECT
MANAGER

INFO
ARCHITECT

YAZ
CLIENT

LEAD
BOSS

KNOWLEDGE
BASE
HOLDER

COMMUNICATOR

PROJECT
MANAGER

QUALITY TESTERS

"WHAT ARE THE BIGGEST PROBLEMS AND HOW DO WE OVERCOME THEM"

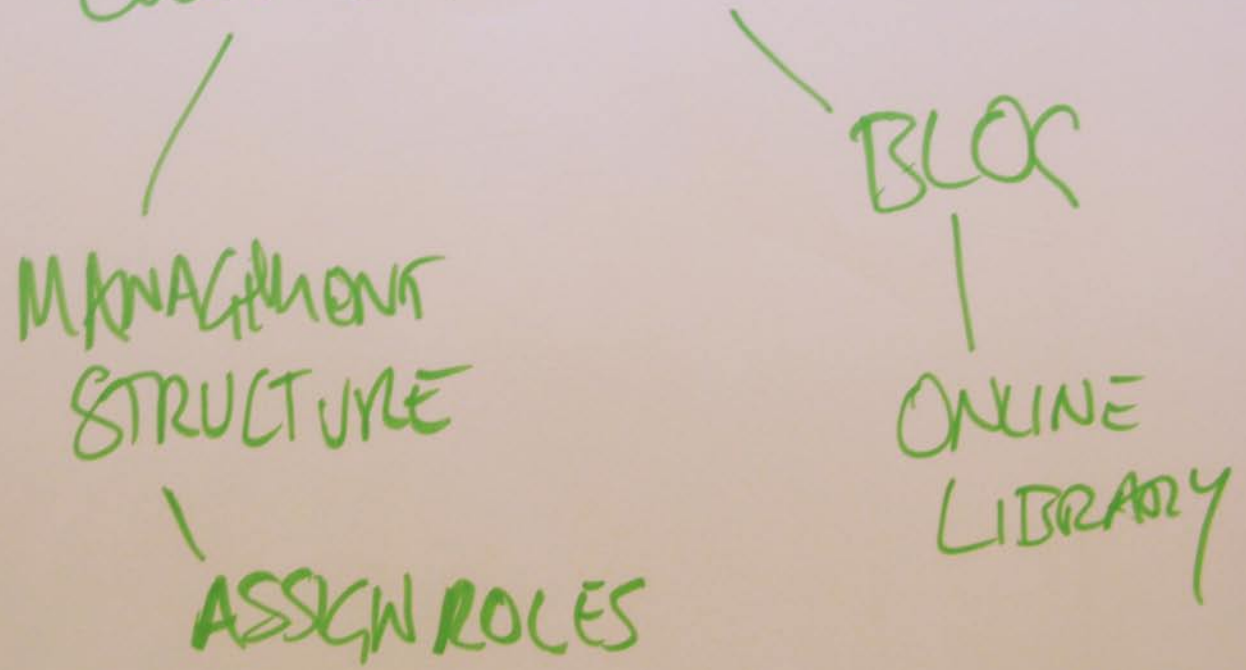



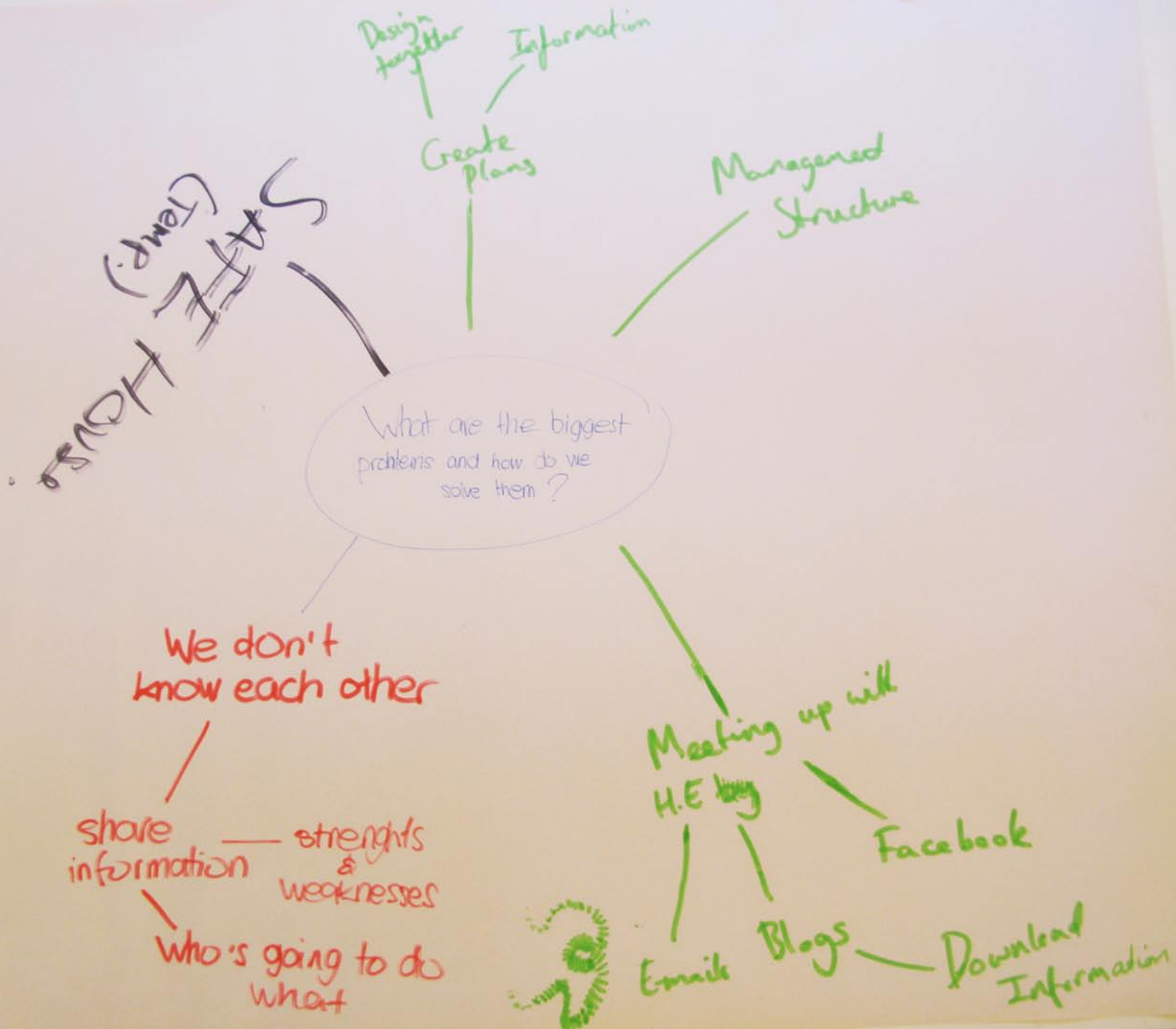



Design together
Information

Create Plans

Managed Structure

Staff House (Temp.)

What are the biggest problems and how do we solve them?

Meeting up with

H.E by

Facebook

Emails

Blogs

Download Information

We don't know each other

share information

strengths & weaknesses

who's going to do what



THREE RULES TO ENSURE
EFFECTIVE COMMUNICATION
betw. "HE" & "FE" &
HOW TO ^{RAY GUN} ALIEN-PROOF
A BUILDING

Annie
Dawina

- ① identify what ray-gun can do
- ② identify what material can protect vs from the Ray Gun.
- ③ Listen, get to know each other,
Smile, REAR Things.

3 Floors
 2 Build-up.
 Outside is Glass
 Green
 soft roof / way?
 decks.

SIXTH FORM
 Des. Stud. B/S.
 - only

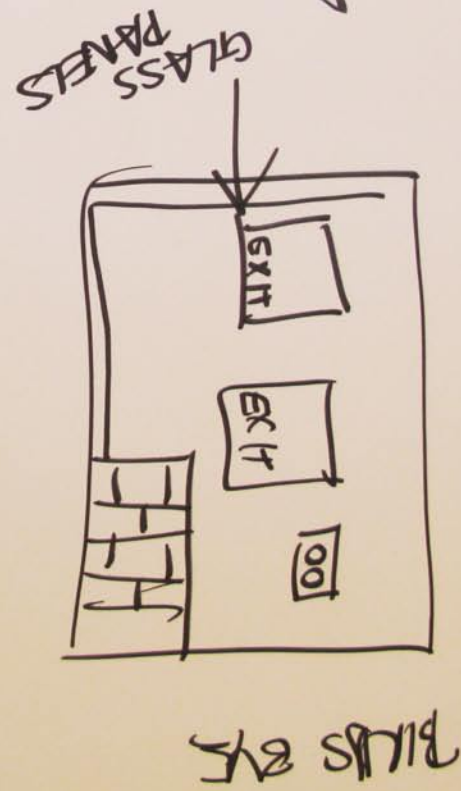

Overall leader
LEADER
for EACH GROUP

AK
ALEX
Robert

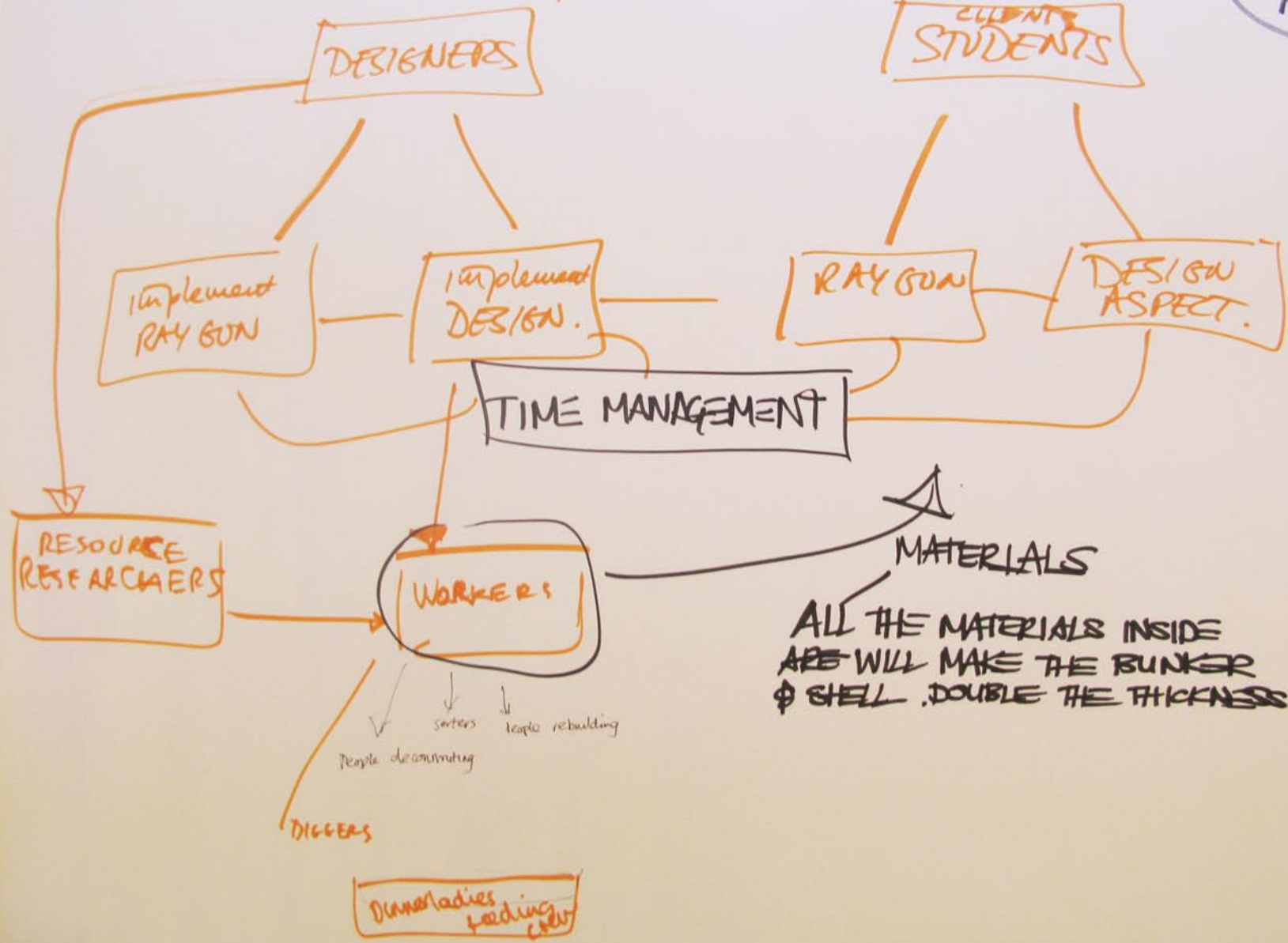

Overall leader

LEADER
for EACH GROUP

ALEX
ALEX
Robert

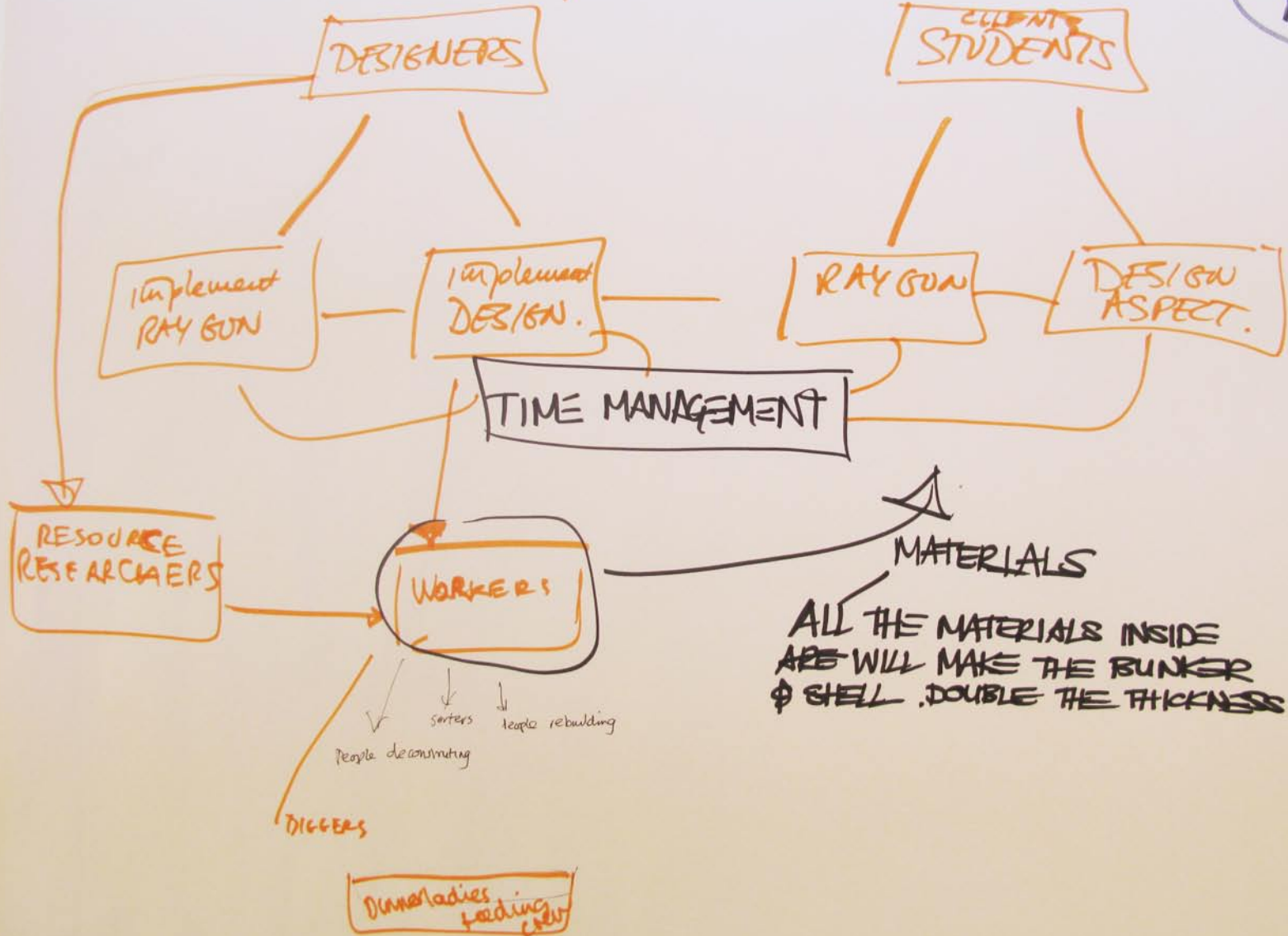

ADEL
CHRIS

What are the biggest problems.... & how do we overcome them?

Team/Roles

Time

Materials

Method

WATER MAINS
(UNDERGROUND)

SUPPLY MAIN

FACILITIES SERVICES

only build outside (structure)
- large walk force.

use old building materials to reinforce...
new N. RG

"Shell" on top as a dummy but subterranean structure.

Defence

control room in "bunker"

SNIPER

EMP

~~SATELLITE~~

SATELLITE

Reflected Shield

Weapons built into "shell"

etc

ADEL
CHRIS

What are the biggest problems....
& how do we overcome them?

Team/Roles

Time

only build outside (structure)
- large work force.

Materials

Use old built materials to reinforce...
new N. RG

Method

"Shell" on top as a dummy but subterranean structure.

Defence

control room in "bunker"

Weapons... built into "shell"

Reflected Shield

etc

WATER MAINS (UNDERGROUND)

FACILITIES SERVICES

SUPPLY WATER

SNIPER

EMP

~~SATELLITE~~
SATELLITE

③ RULES TO ENSURE EFFECTIVE DELEGATION OF TASKS

Hannah
Dauirelle

- ① clear structure > knowing what people can/can't do (LIST)
- ② checker & somebody checking up on what is/is not being done.
- ③ Re checker & somebody re delegating, re design improve